

RTB薄型油壓缸 RTB Hydraulic thin-type Cylinder

●油缸內徑Φ20-Φ80 ●最大操作壓力140kg/cm² ●Bore of cylinder (mm) : Φ20-Φ80 ● Max pressure:140kg/cm²

SD 軸向安裝型(單軸)Φ20-Φ80
SD Axial Mounting Type(Single End Rod)



SW 軸向安裝型(雙軸)Φ32-Φ80
SW Axial Mounting Type(Double End Rod)



SDM-A 軸向前油路板型 Φ20-Φ80
SDM-A Axial Front Manifold Type

SDM-B 軸向後油路板型 Φ20-Φ80
SDM-B Axial Back Manifold Type



RTM 薄型感應油壓缸 Φ32-Φ80
RTM Magnetic-type hydraulic cylinder

LA 側向安裝型(單軸)Φ32-Φ63
LA Side Mounting Type(Single End Rod)

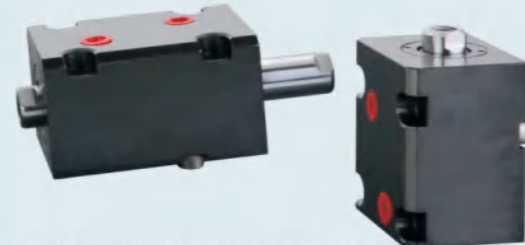

LW 側向安裝型(雙軸)Φ32-Φ63
LW Side Mounting Type(Double End Rod)

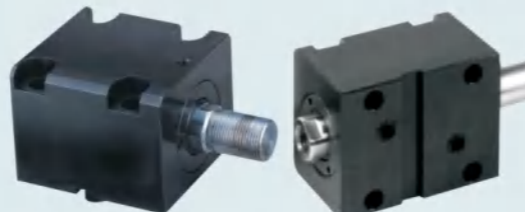

LAM 側向油路板型(單軸)Φ32-Φ63
LAM Side Mounting Type(Single End Rod)

LWM 側向油路板型(雙軸)Φ32-Φ63
LWM Side Mounting Type(Double End Rod)

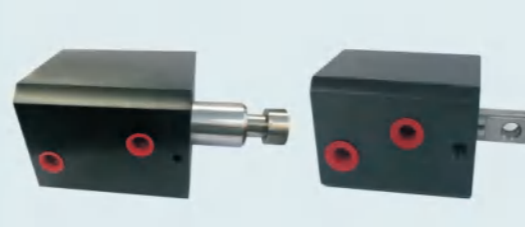

軸端型式接受訂制, 訂購時請提供尺寸Φ20-Φ80
Rod end type as request

行程規格表 Stroke specifications

注: 記號“-”之油缸本體長度須加長5mm

TYPE BORE STROKE	SD SDM		SD SDM					SW LA LW				LAM LWM			
	Φ20	Φ25	Φ32	Φ40	Φ50	Φ63	Φ80	Φ32	Φ40	Φ50	Φ63	Φ32	Φ40	Φ50	Φ63
5	-	-	●	●	●	●	●	-	-	-	-	-	-	-	-
10	●	●	●	●	●	●	●	●	●	●	●	-	-	-	-
15	-	-	●	●	●	●	●	-	-	-	-	-	-	-	-
20	●	●	●	●	●	●	●	●	●	●	●	●	●	●	●
25	-	-	●	●	●	●	●	-	-	-	-	-	-	-	-
30	●	●	●	●	●	●	●	●	●	●	●	●	●	●	●
40	-	●	●	●	●	●	●	●	●	●	●	●	●	●	●
50	-	●	●	●	●	●	●	●	●	●	●	●	●	●	●

注: 需訂做其它行程請來電諮詢

RTB薄型油壓缸 RTB Hydraulic thin-type Cylinder

●油缸內徑Φ20-Φ80 ●最大操作壓力140kg/cm² ●Bore of cylinder (mm) : Φ20-Φ80 ● Max pressure:140kg/cm²

訂購標示法 Ordering Code

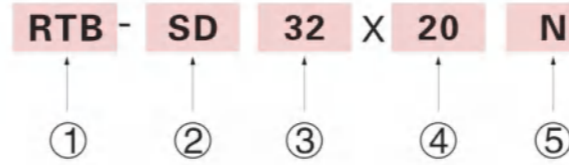

① 系列號 Series	RTB	
② 安裝型式 Mounting type	SD	軸向單軸 Single end rod type
	SW	軸向雙軸 Double end rod type
③ 缸體內徑 Bore of cylinder	Φ20, Φ25, Φ32, Φ40, Φ50, Φ63, Φ80	
④ 準行程 Standard stroke	請參考行程規格表 Please refer to the stroke specification	
⑤ 軸端形式 Rod end type	內牙N: Female thread N	
	外牙W: Male thread W	

SD-N

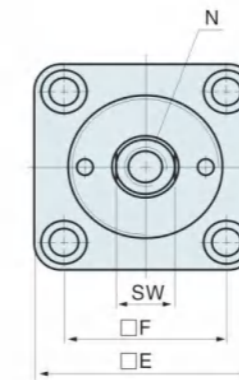
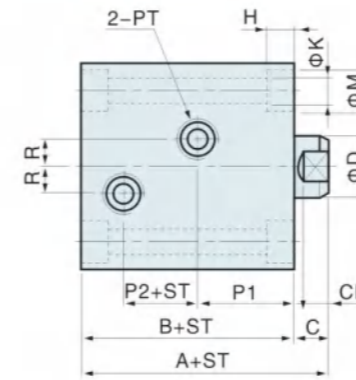

SD-W

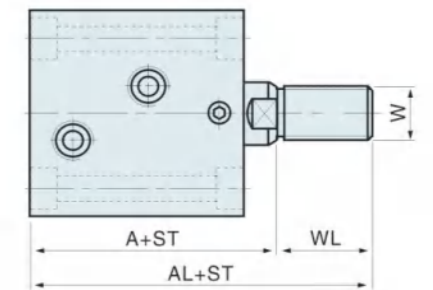

SW-N

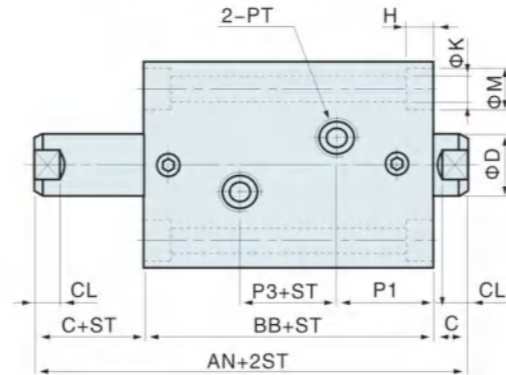

SW-W

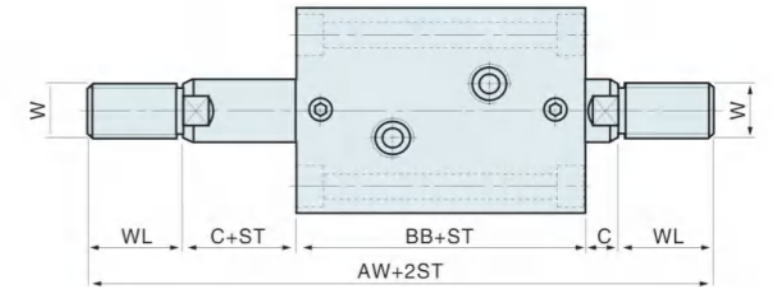

ST=Stroke

外形尺寸表 Dimension table

單位 (Unit) : mm

Bore	A	AL	AN	AW	B	BB	C	CL	D	SW	E	F	H	K	M	N	W	WL	P1	P2	P3	R	PT
Φ20	51	71	-	-	43	-	8	6	12	10	42	30	5.5	5.6	9	M8x1.25x12D	M10x1.25	20	22.5	11	-	5	1/8
Φ25	53	75	-	-	45	-	8	6	14	12	48	36	5.5	5.6	9	M10x1.5x15D	M12x1.25	22	23	12	-	5	1/8
Φ32	64	89	89	139	54	69	10	7	20	17	62	47	6.5	6.8	11	M12x1.75x15D	M16x1.5	25	28	14	13	10	1/4
Φ40	65	95	90	150	55	70	10	7	25	22	70	52	9	9	14	M16x2.0x20D	M22x1.5	30	28	15	14	10	1/4
Φ50	71	106	97	167	60	75	11	8	30	27	80	58	11	11	18	M20x2.5x25D	M26x1.5	35	29.5	18	16	10	1/4
Φ63	80	120	108	188	67	82	13	10	35	32	94	69	13	13	20	M27x3.0x35D	M30x1.5	40	31	20	20	10	3/8
Φ80	95	140	127	217	78	93	17	14	45	41	114	86	15	15	22	M30x3.5x35D	M39x1.5	45	33	27	27	15	3/8

RTB油路板型油壓缸(SDMA/SDMB) RTB Hydraulic manifold type SDMA/SDMB

●油缸內徑Φ20-Φ80 ●最大操作壓力140kg/cm² ●Bore of cylinder (mm) : Φ20-Φ80 ●Max pressure:140kg/cm²

訂購標示法 Ordering Code

RTB - SDMA 32 X 20 N

① ② ③ ④ ⑤

① 系列號 Series	RTB	
② 安裝型式 Mounting type	SDMA 軸向前油路板型 Axial front manifold type	SDMB 軸向後油路板型 Axial back manifold type
③ 缸體內徑 Bore of cylinder	Φ20, Φ25, Φ32, Φ40, Φ50, Φ63, Φ80	
④ 標準行程 Standard stroke	請參考行程規格表 Please refer to the strike specification	
⑤ 軸端形式 Rod end type	內牙N: Female thread N 外牙W: Male thread W	

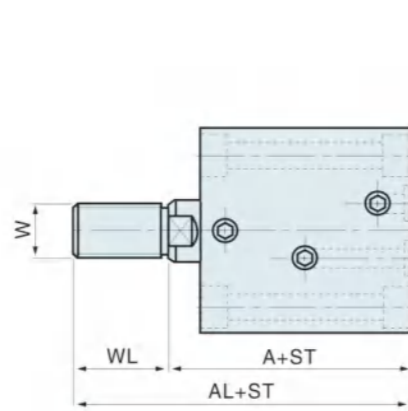
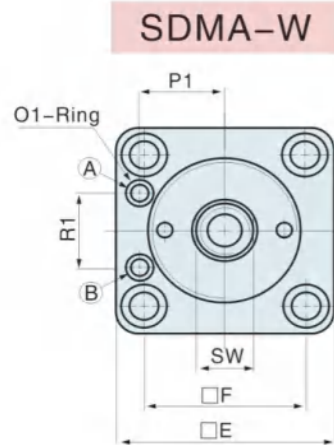
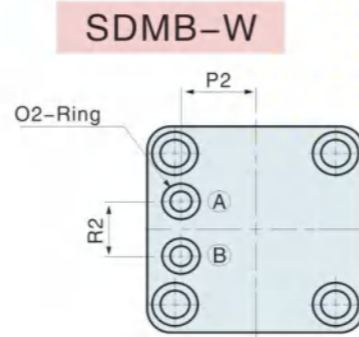
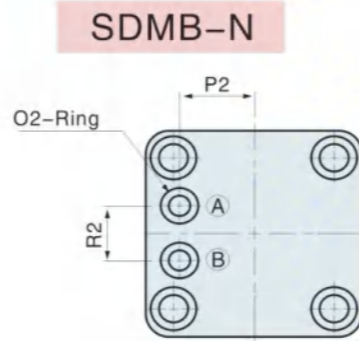
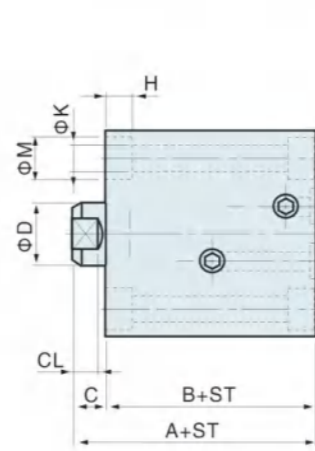
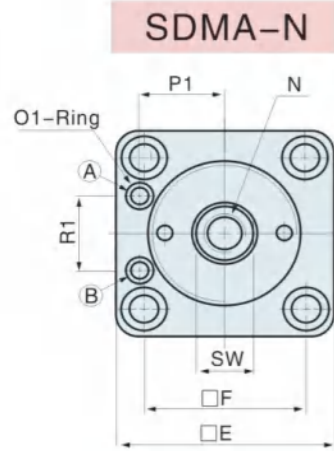

ST=Stroke

A 推出油孔 Push out
B 拉入油孔 Pull in

外形尺寸表 Dimension table

單位 (Unit) : mm

Bore	A	AL	B	C	CL	D	SW	E	F	H	K	M	N	W	WL	SDMA				SDMB			
																P1	R1	O1	P2	R2	O2	P2	R2
Φ20	51	71	43	8	6	12	10	42	30	5.5	5.6	9	M8×1.25×12D.	M10×1.25	20	16.5	13	P3	13	11	P5		
Φ25	53	75	45	8	6	14	12	48	36	5.5	5.6	9	M10×1.5×15D.	M12×1.25	22	19.5	18	P4	16	13	P7		
Φ32	64	89	54	10	7	20	17	62	47	6.5	6.8	11	M12×1.75×15D.	M16×1.5	25	24	24	P6	20	20	P9		
Φ40	65	95	55	10	7	25	22	70	52	9	9	14	M16×2.0×20D.	M22×1.5	30	27	26	P6	24	20	P9		
Φ50	71	106	60	11	8	30	27	80	58	11	11	18	M20×2.5×25D.	M26×1.5	35	32	27	P6	29	20	P9		
Φ63	80	120	67	13	10	35	32	94	69	13	13	20	M27×3.0×35D.	M30×1.5	40	38	35	P8	35	26	P11		
Φ80	95	140	78	17	14	45	41	114	86	15	15	22	M30×3.5×35D.	M39×1.5	45	47	45	P11	44	30	P11		

RTB薄型油壓缸(LA/LW) RTB Hydraulic thin-type Cylinder LA/LW

●油缸內徑Φ32-Φ63 ●最大操作壓力140kg/cm² ●Bore of cylinder (mm) : Φ32-Φ63 ●Max pressure:140kg/cm²

訂購標示法 Ordering Code

RTB - LA 32 X 20 N

① ② ③ ④ ⑤

① 系列號 Series	RTB	
② 安裝型式 Mounting type	LA 側向單軸 Single end rod type	LW 側向雙軸 Double end rod type
③ 油缸內徑 Bore of cylinder	Φ32, Φ40, Φ50, Φ63	
④ 標準行程 Standard stroke	10.20.30.40.50	
⑤ 軸端型式 Rod end type	內牙N: Female thread N 外牙W: Male thread W	

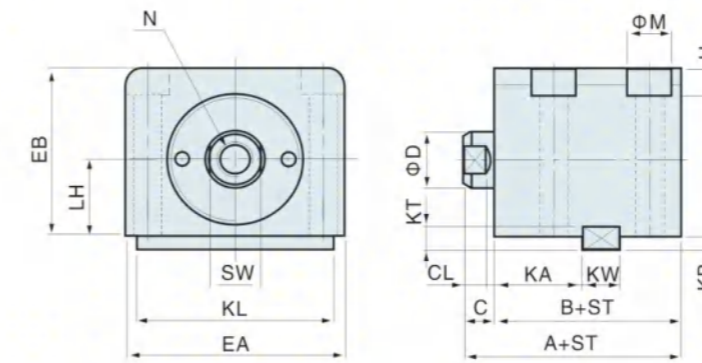
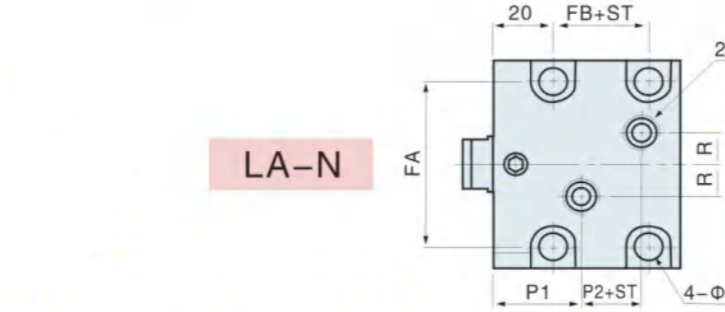

LW-N

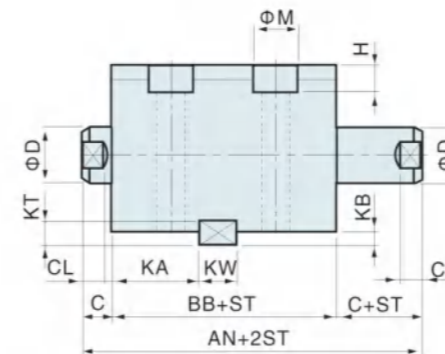
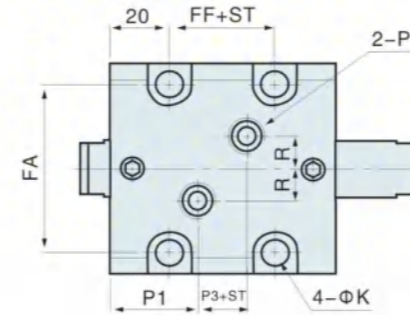

LA-W

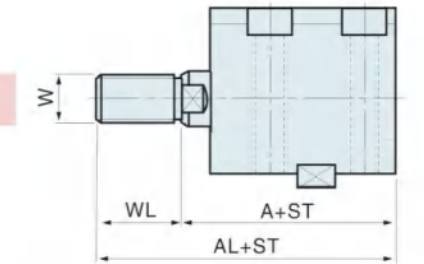

LW-W

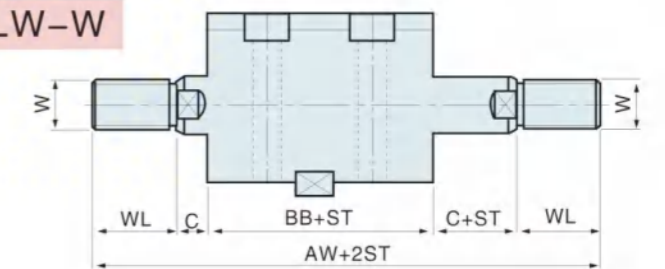

KEY



外形尺寸表

Dimension table 單位 (Unit) : mm

Bore	KW	KT	KL	KA	KB
Φ32	12	8	63	28	4.5
Φ40	12	8	70	28	4.5
Φ50	14	9	80	29	5
Φ63	16	10	100	31	5.5

外形尺寸表 Dimension table

單位 (Unit) : mm

Bore	A	AL	AN	AW	B	BB	C	CL	D	SW	EA	EB	LH	FA	FB	FF	H	K	M	N	W	WL	P1	P2	P3	R	PT
Φ40	65	95	90	150	55	70	10	7	25	22	80	64	29	62	23	32	11	11	18	M16×2.0×20D	M22×1.5	30	28	15	14	10	1/4
Φ50	71	106	97	167	60	75	11	8	30	27	94	74	34	74	27	35	13	13	20	M20×2.5×25D	M26×1.5	35	29.5	18	16	10	1/4
Φ63	80	120	108	188	67	82	13	10	35	32	114	89	42	90	32	42	15	15	22	M27×3.0×35D	M30×1.5	40	31	20	20	10	3/8

RTB油路板型油壓缸(LAM/LWM)RTB Hydraulic manifold type LAM/LWM

●油缸內徑Φ32-Φ63 ●最大操作壓力140kg/cm² ●Bore of cylinder (mm) : Φ32-Φ63 ●Max pressure:140kg/cm²

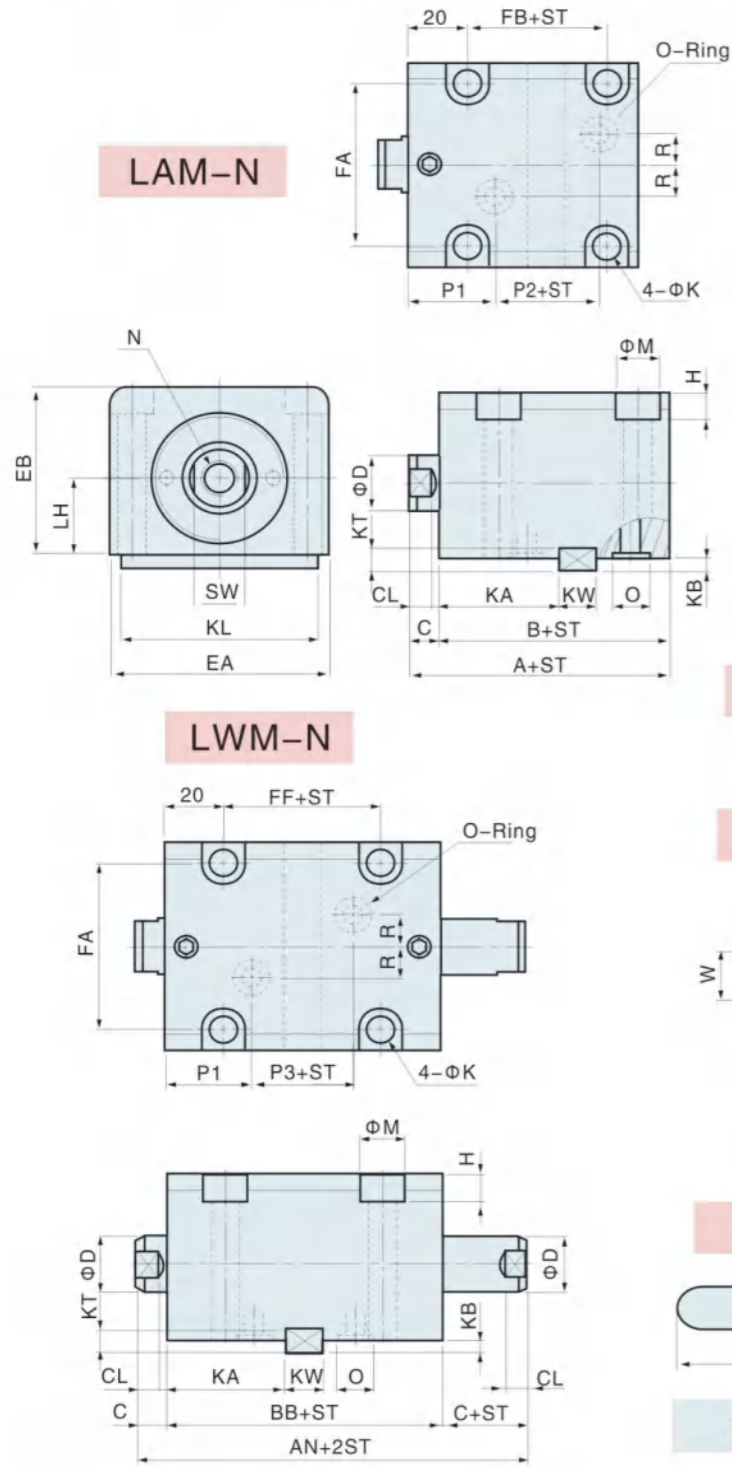

訂購標示法 Ordering Code

RTB - LAM 32 × 20 N

① ② ③ ④ ⑤

① 系列號 Series	RTB
② 安裝型式 Mounting type	LAM 側向單軸 Single end rod type LWM 側向雙軸 Double end rod type
③ 油缸內徑 Bore of cylinder	Φ32, Φ40, Φ50, Φ63
④ 標準行程 Standard stroke	10.20.30.40.50
⑤ 軸端型式 Rod end type	內牙N: Female thread N 外牙W: Male thread W

注: 行程10mm無附鍵槽及平鍵
Stroke: 10mm without key.

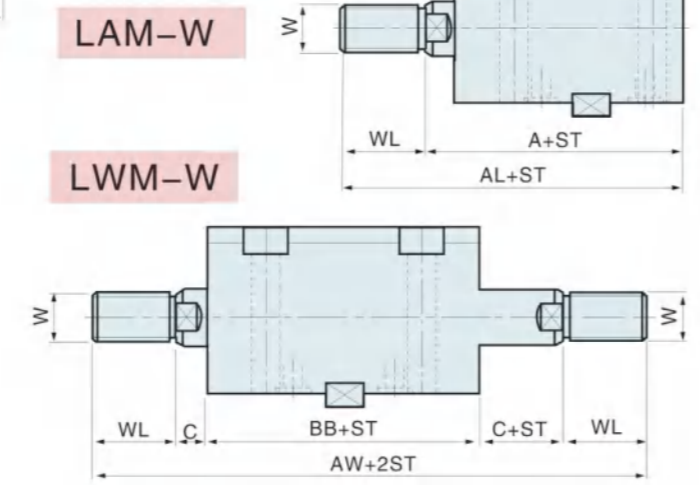

KEY

KL, KT, KW, ST=Stroke

外形尺寸表 Dimension table 單位 (Unit) : mm

Bore	KW	KT	KL	KA	KB
Φ32	12	8	63	38	4.5
Φ40	12	8	70	38	4.5
Φ50	14	9	80	40	5
Φ63	16	10	100	42	5.5

外形尺寸表 Dimension table 單位 (Unit) : mm

Bore	A	AL	AN	AW	B	BB	C	CL	D	SW	EA	EB	LH	FA	FB	FF	H	K	M	N	W	WL	P1	P2	P3	R	O
Φ32	64	89	89	139	54	69	10	7	20	17	70	56	25	56	24	32	9	9	14	M12×1.75×15D	M16×1.5	25	28	14	13	10	P9
Φ40	65	95	90	150	55	70	10	7	25	22	80	64	29	62	23	32	11	11	18	M16×2.0×20D	M22×1.5	30	28	15	14	10	P9
Φ50	71	106	97	167	60	75	11	8	30	27	94	74	34	74	27	35	13	13	20	M20×2.5×25D	M26×1.5	35	29.5	18	16	10	P11
Φ63	80	120	108	188	67	82	13	10	35	32	114	89	42	90	32	42	15	15	22	M27×3.0×35D	M30×1.5	40	31	20	20	10	P11

HTM70鋁合金缸體薄型感應油壓缸(SD.SDMB) Tm70 Magnetic-Type Hydraulic Cylinder SD.SDMB

●油缸內徑Φ32-Φ80 ●最大操作壓力70kg/cm² ●Bore of cylinder (mm) : Φ32-Φ80 ●Max pressure:70kg/cm²

訂購標示法 Ordering Code

HTM70 - SD 32 × 20 N - S1

① ② ③ ④ ⑤ ⑥

① 系列號 Series	HTM70	
② 安裝型式 Mounting type	SD 标准型 Standard	SDMB 油路板型 Manifold type
③ 油缸內徑Bore of cylinder	Φ32, Φ40, Φ50, Φ63, Φ80	
④ 標準行程 Standard stroke	10.20.30.40.50	
⑤ 軸端型式 Rod end type	內牙:N Female thread N	外牙:W Male thread W
⑥ 近接開關 Sensor swithth	1個pcsS1	2個pcsS2
	電壓PressureDC4-24V	電流Electricity5-40mA AC4-120V

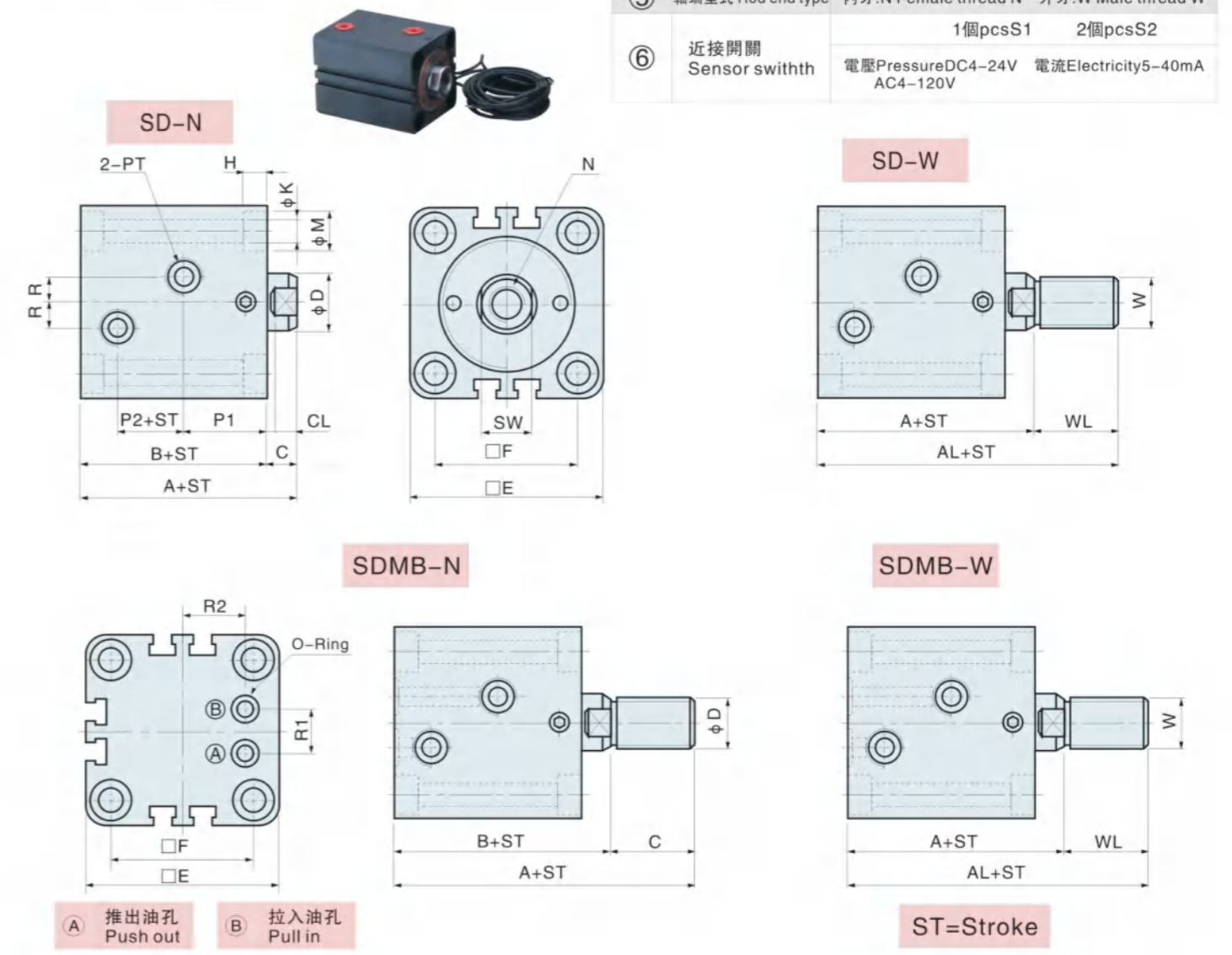

外形尺寸表 Dimension table 單位 (Unit) : mm

Bore	A	AL	B	C	CL	D	SW	E	F	H	K	M	N	W	WL	SD		SDMB				
																P1	P2	R	PT	R1	R2	O
Φ32	64	89	54	10	7	20	17	62	47	6.5	6.8	11	M12×1.75×15D	M16×1.5	25	28	14	10	1/4	20	20	P9
Φ40	65	95	55	10	7	25	22	70	52	9	9	14	M16×2.0×20D	M22×1.5	30	28	15	10	1/4	20	24	P9
Φ50	70	106	60	11	8	30	27	80	58	11	11	18	M20×2.5×25D	M26×1.5	35	29.5	18	10	1/4	20	29	P9
Φ63	80	120	67	13	10	35	32	94	69	13	13	20	M27×3.0×35D	M30×1.5	40	31	20	10	3/8	26	35	P11
Φ80	95	140	78	17	14	45	36	114	86	15	15	22	M30×3.5×35D	M39×1.5	45	33	27	15	3/8	30	44	P11

●油缸內徑Φ32-Φ80 ●最大操作壓力140kg/cm² ●Bore of cylinder (mm) : Φ32-Φ80 ● Max pressure:140kg/cm²

訂購標示法 Ordering Code

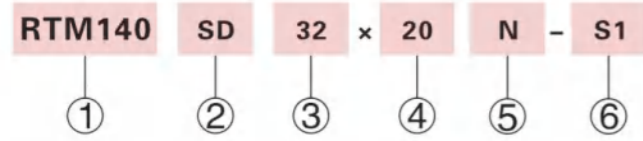

① 系列號 Series	RTM	
② 安裝型式 Mounting type	SD 軸向 單軸 Sing end rod type	SW 軸向 雙軸 Double end rod type
③ 油缸內徑Bore of cylinder	Φ 32, Φ 40, Φ 50, Φ 63, Φ 80	
④ 標準行程 Standard stroke	10, 20, 30, 40, 50	
⑤ 軸端型式 Rod end type	內牙:N Female thread N 外牙:W Male thread W	
⑥ 近接開關 Sensor swithth	1個pcsS1 2個pcsS2 電壓PressureDC4-24V 電流Electricity5-40mA AC4-120V	

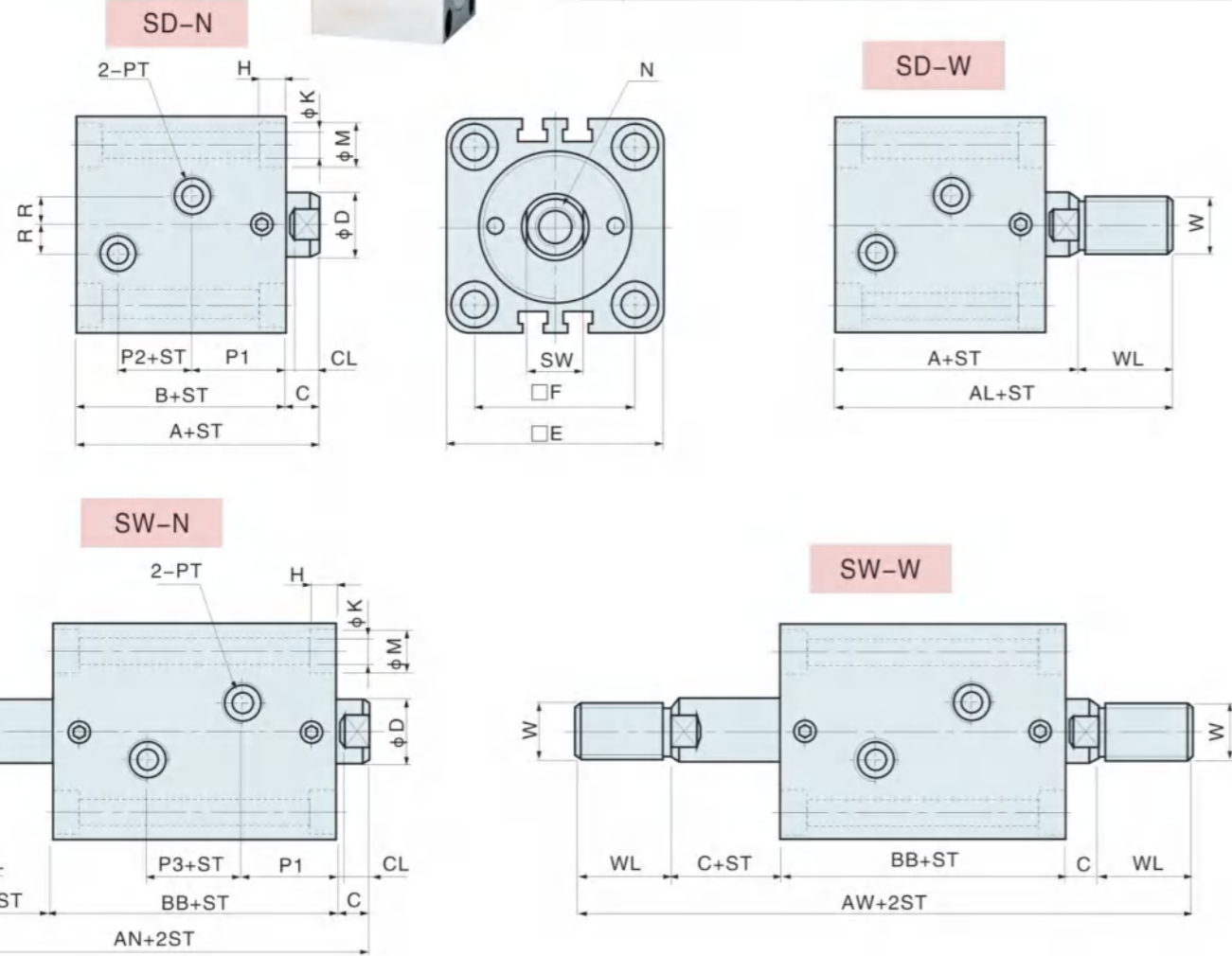

外形尺寸表 Dimension table

單位 (Unit) :mm

Bore	A	AL	AN	AW	B	BB	C	CL	D	SW	E	F	H	K	M	N	W	WL	P1	P2	P3	R	PT
Φ 32	83	108	104	154	73	84	10	7	20	17	62	47	6.5	6.8	11	M12×1.75×15D	M16×1.5	25	27	29	30	10	1/4
Φ 40	80	110	101	161	70	81	10	7	25	21	70	52	9	9	14	M16×2.0×20D	M20×1.5	30	27	27	27	10	1/4
Φ 50	86	121	109	179	75	87	11	8	30	27	80	58	11	11	18	M20×2.5×25D	M24×1.5	35	28	31	31	10	1/4
Φ 63	97	142	120	210	84	94	13	10	35	32	94	69	13	13	20	M27×3.0×33D	M30×1.5	45	30	36	34	10	1/4
Φ 80	112	167	140	250	95	106	17	14	40	37	114	86	15	15	22	M30×3.5×33D	M36×1.5	55	35	38	36	15	3/8

●油缸內徑Φ16-Φ40 ●最大操作壓力300kg/cm² ●Bore of cylinder(mm):Φ16-Φ40 ●Max pressure:300kg/cm²

注: 操作壓力P: (300<P<500)可訂做

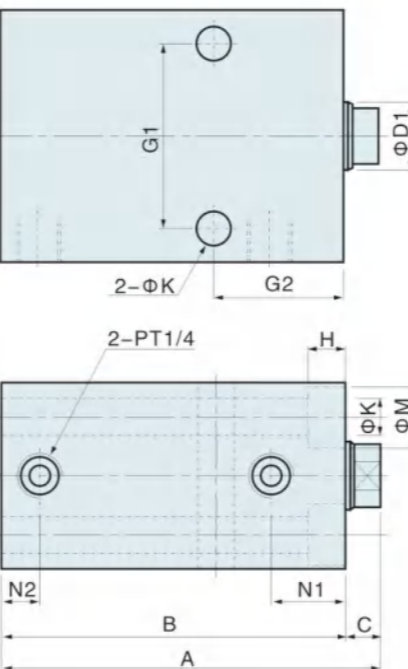

產品簡介

- ◆本系列油壓缸為德規尺寸, 採用進口油封保證耐壓, 標準化規格, 互換性高。
- ◆安裝型式為軸向、側向兩用型, 作動方式分為單動常入型與復動式。

Introduction of product

- ◆The series of hydraulic cylinder complies with Germany specifications. Employ imported oil seal for outstanding pressure resistance. Standardized specifications and full interchangeability.
- ◆Axial and side mounting type. Choice of single and double acting.

理論出力表 Clamping force

油缸內徑 Bore of cylinder (mm)	活塞杆徑 Piston-rod (mm)	受壓面積 Pressure area(cm ²)		操作壓力 Operation pressure kg/cm ²			
		F1	F2	100		500	
Φ 16	Φ 10	2.01	1.22	201	122	1005	610
Φ 25	Φ 16	4.91	2.9	491	290	2455	1450
Φ 32	Φ 20	8.04	4.9	804	490	4020	2450
Φ 40	Φ 25	12.57	7.66	1257	766	6285	3830

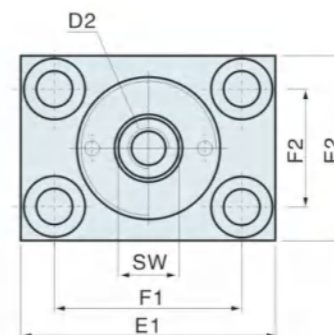

F1: 推出 Pushout
F2: 拉入 Pullin

訂購標示法 Order Code

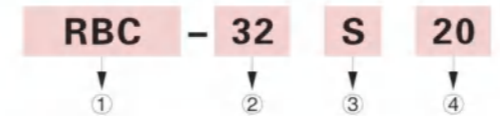

① 系列號 Series	RBC	
② 油缸內徑 Bore of cylinder	Φ 16, Φ 25, Φ 32, Φ 40	
③ 作動方式 Acting type	S 單動 Single-acting	D 雙動 Double-acting
④ 標準行程 Standard stroke	請參考尺寸表 Refer to the dimensional table	

外形尺寸表 Dimension table

Bore	Single acting		Double acting		C	D1	D2	SW	E1	E2	F1	F2	G1	G2	H	K	M	N1	N2		
	Stroke	A	B	Stroke																A	B
Φ 16	8	62	56	16	62	56	6	10	M6x1.0	8	60	35	40	22	30	30	6.5	6.8	11	16.5	11
	20	97	91	50	97	91	7	16	M10x1.5	13	65	45	50	30	50	33	9	9	14	18	11
Φ 25	8	71	64	20	71	64	7	16	M10x1.5	13	65	45	50	30	50	33	9	9	14	18	11
	20	101	94	50	101	94	7	16	M10x1.5	13	65	45	50	30	50	33	9	9	14	18	11
Φ 32	10	85	75	25	85	75	10	20	M12x1.75	17	75	55	55	35	55	38	11	11	18	22	11
	20	110	100	50	110	100	10	20	M12x1.75	17	75	55	55	35	55	38	11	11	18	22	11
Φ 40	10	89	79	25	89	79	10	25	M16x2.0	22	85	63	63	40	63	40	11	11	18	24	11
	20	114	104	50	114	104	10	25	M16x2.0	22	85	63	63	40	63	40	11	11	18	24	11

RLCK 杠杆式油壓缸 RLCK Hydraulic Leverage-type Cylinder

●油缸內徑Φ25-Φ63 ●最大操作壓力50kg/cm² ●Bore of cylinder(mm):Φ25-Φ63 ●Max pressure:50kg/cm²



360° 任意调节角度

產品簡介

- ◆此型式油壓缸,夾持機構為杠杆原理,活塞推出為夾緊狀態,夾持力大于轉角缸,主要機構零件安裝開缸體外部,易于維護。
- ◆缸體及夾持機構材料均採用機械構造用碳素鋼,堅固耐用,使用壽命長。
- ◆活塞材質採用45鋼,熱處理,表面鍍鉻。
- ◆壓板需增加長度時,請勿大于原長度之1.5倍。

Introduction of product

- ◆The clamp structure of this model is based on the lever principle: it will be tightened as piston pushing out. The clamping force is stronger than the swing clamp cylinder's. The parts are installed outside the cylinder barrel for maintaining easily.
- ◆The cylinder barrel and clamp structure are made of carbon steel. It is firm, durable and long-lived to use.
- ◆The material of the piston is 45# steel, heat treatment, chrome plated.
- ◆Please don't exceed 1.5 times of the original length, if you need to increase the length of the clamping arm.

特性資料 Specification

油缸內徑	Bore of cylinder (mm)	φ25	φ32	φ40	φ50	φ63
活塞杆徑	Bore of piston (mm)	φ18	φ20	φ22.4	φ28	φ35.5
總行程	Total stroke (mm)	25	25	30	34	40
受壓面積推出	Pressure area push cm ²	4.91	8.04	12.57	19.63	31.17
理論夾持力	Theoretical clamping 30kg/cm ²	116kg	190kg	288kg	453kg	701kg
使用流體	Fluid	已濾清之標準液壓油 Filtered oil				
使用溫度範圍	Range of temperature	-10~+60°C				
最大耐壓力	Max operation pressure (kg/cm ²)	70kg/cm ²				
使用壓力範圍	Range of pressure (kg/cm ²)	10-50kg/cm ²				
作動方式	Acting type	復動式 Double acting				

訂購標示法 Ordering Code



RLCK 杠杆式油壓缸 RLCK Hydraulic Leverage-type Cylinder

●油缸內徑Φ25-Φ63 ●最大操作壓力50kg/cm² ●Bore of cylinder(mm):Φ25-Φ63 ●Max pressure:50kg/cm²

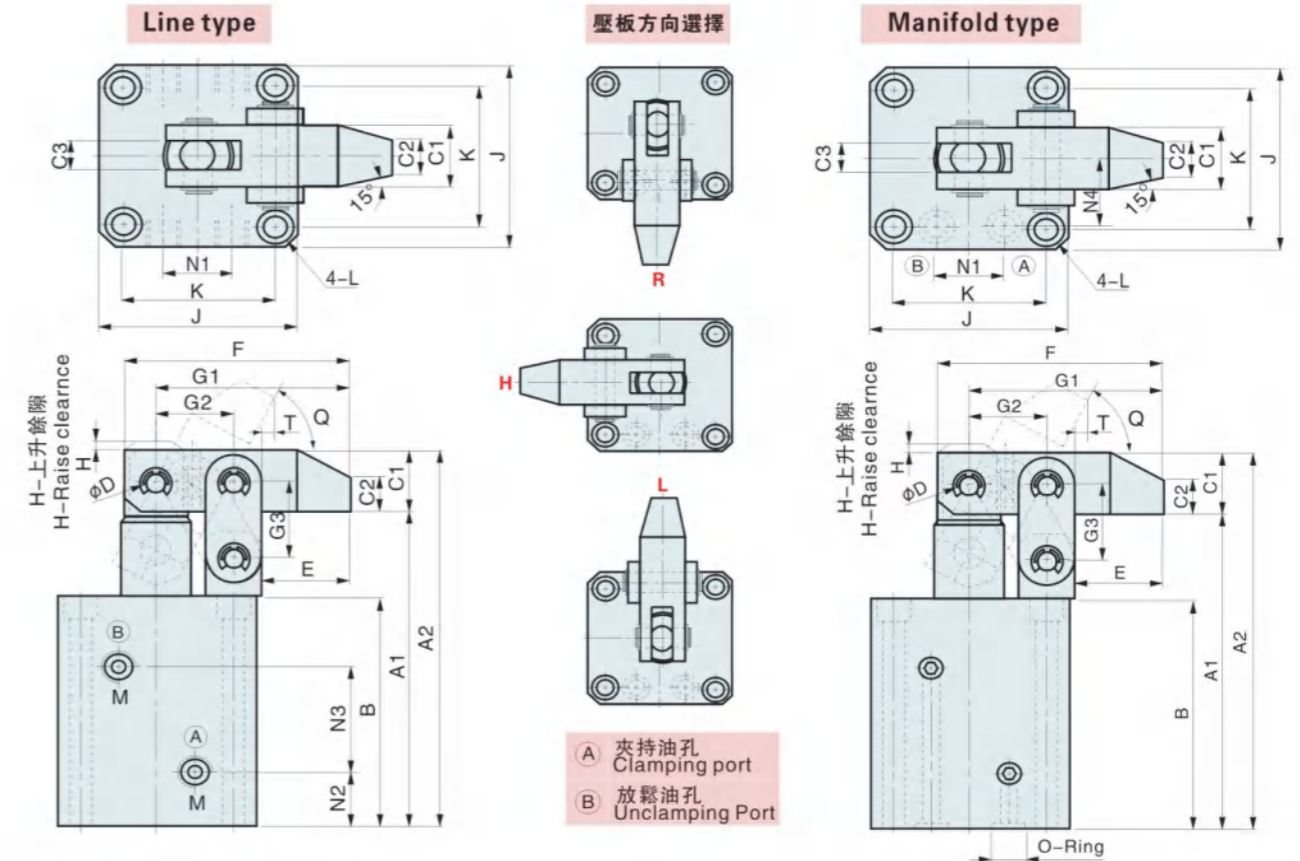

外形尺寸表 Dimension table

ITEM	MODEL	RLCK-25 RLCK-M25	RLCK-32 RLCK-M32	RLCK-40 RLCK-M40	RLCK-50 RLCK-M50	RLCK-63 RLCK-M63
A1		103	112	122	137	155
A2		122	131	144	162	187
B		76	85	90	100	111
C1		□19	□19	□22	□25	□32
C2		11	11	13	15	19
C3		9	9	10	11	15
φD		φ8	φ8	φ10	φ12	φ15
E		25	25	30	35.5	43
F		64	64	77	90	110
G1		55	55	66	77	94
G2		22	22	26	30	36
G3		24	24	29	33	39
H		3	3	4	4	4
J		55	57	69	75	96
K		42	44	52	58	75
L		φ6.8-φ10.5×6.5D.	φ6.8-φ10.5×6.5D.	φ9-φ14×9D.	φ9-φ14×9D.	φ11-φ18×11D.
M		PT1/8	PT1/8	PT1/4	PT1/4	PT1/4
N1		18	22	26	32	38
N2		17	19	19	21.5	22
N3		33	38	40	45	52
N4		20	22	26	29	38
O-Ring		P7	P7	P8	P8	P9
Q		61°	61°	61°	61°	66°
T		4	5	5.5	7.5	7.5

RLCK杠杆式油壓缸(MF油路板附調速/FA法蘭型)

RLCK Hydraulic Leverage-type Cylinder MF.FA Manifold with flow contrd/Flange type

●油缸內徑Φ25-Φ50 ●最大操作壓力50kg/cm² ●Bore of cylinder(mm):Φ25-Φ50 ●Max pressure:50kg/cm²

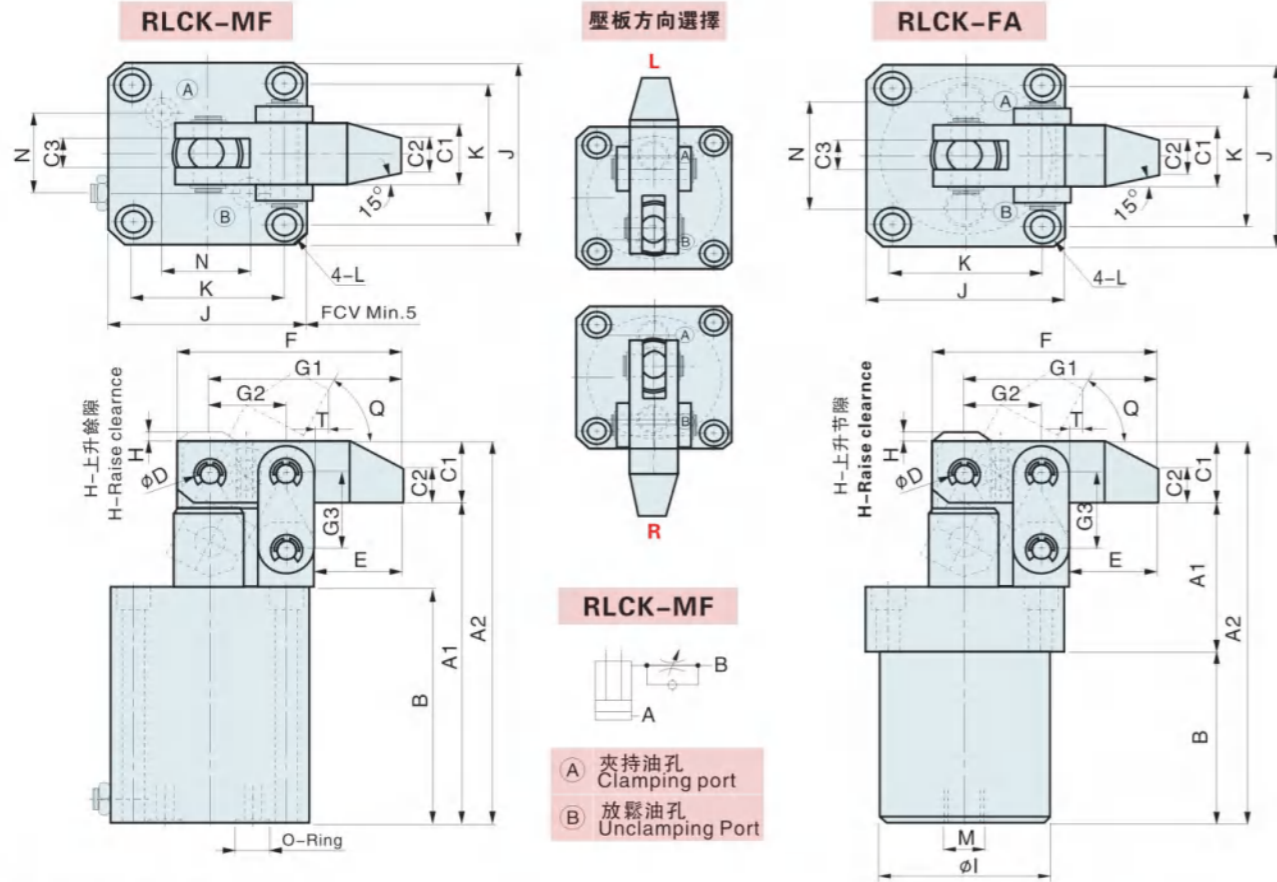

外形尺寸表 Dimension table

單位 (Unit) :mm

MODEL ITEM	MF25	MF32	MF40	MF50	MF 63	FA25	FA32	FA40	FA50	FA 63
A1	112	115	130	145	163	49	52	57	67	77
A2	131	134	152	170	195	131	134	152	170	194.8
B	85	88	98	108	119	63	63	73	78	86
C1	□19	□19	□22	□25	□31.8	□19	□19	□22	□25	□31.8
C2	11	11	13	15	19	11	11	13	15	19
C3	9	9	10	11	15	9	9	10	11	15
ΦD	Φ8	Φ8	Φ10	Φ12	Φ15	Φ8	Φ8	Φ10	Φ12	Φ15
E	25	25	30	35.5	43	25	25	30	35.5	43
F	64	64	77	90	110	64	64	77	90	110
G1	55	55	66	77	94	55	55	66	77	94
G2	22	22	26	30	36	22	22	26	30	36
G3	24	24	29	33	39	24	24	29	33	39
H	3	3	4	4	4	3	3	4	4	4
ΦI	—	—	—	—	—	Φ45	Φ50	Φ58	Φ68	Φ87
J	55	57	69	75	96	55	57	69	75	96
K	42	44	52	58	75	42	44	52	58	75
L	Φ6.8-Φ10.5X6.5D.	Φ9-Φ14X9D.	Φ11-Φ18x11D	Φ6.8-Φ10.5X6.5D.	Φ9-Φ14X9D.	Φ11-Φ17x11D				
M	—	—	—	—	—	PT1/4	PT1/4	PT1/4	PT1/4	PT1/4
N	19	21	23	28	35	25	32	40	50	63
O-Ring	P7	P7	P9	P9	P9	—	—	—	—	—
Q	61°	52°	58°	61°	66°	61°	61°	61°	61°	61°
T	4	11	7.5	7.5	7.5	4	5	5.5	7.5	7.5

RLCK杠杆式油壓缸(FAM法蘭型油路板)

RLCK Hydraulic Leverage-type Cylinder FAM Flange with manifold

●油缸內徑Φ25-Φ50 ●最大操作壓力50kg/cm² ●Bore of cylinder(mm) : Φ25-Φ50 ●Max pressure:50kg/cm²

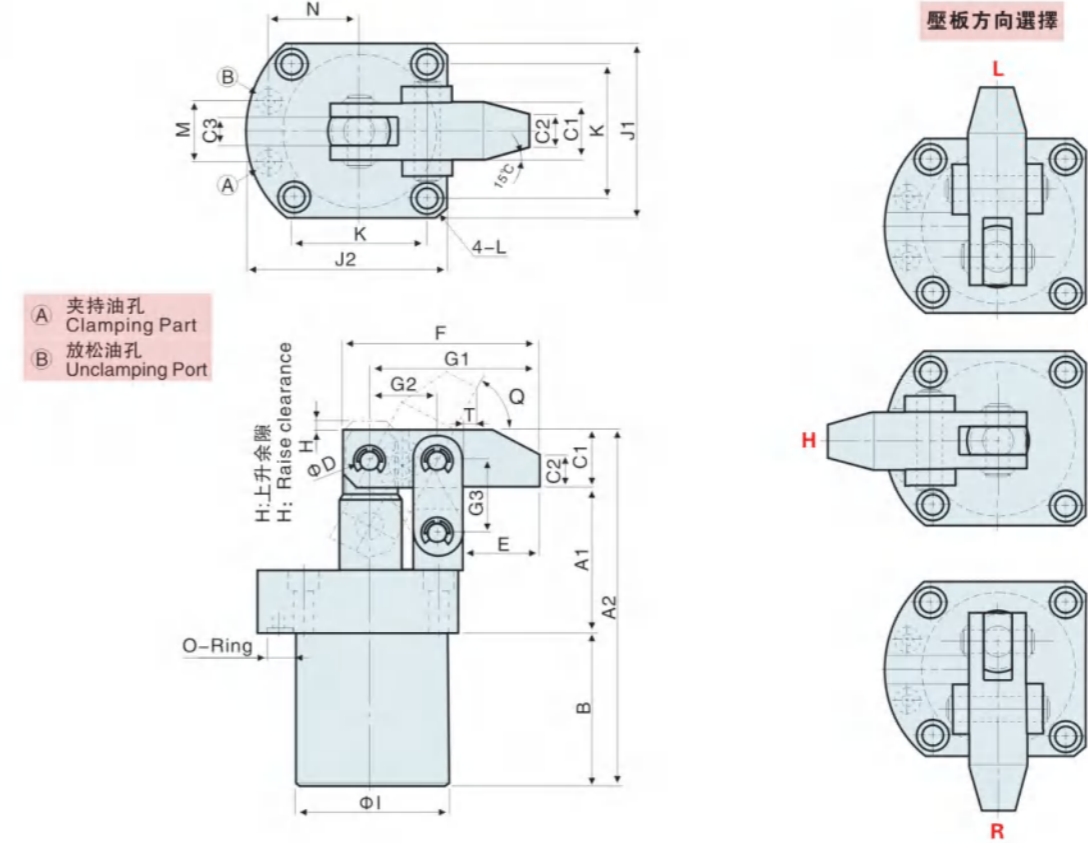

外形尺寸表 Dimension table

ITEM	MODEL	RLCK-FAM25	RLCK-FAM32	RLCK-FAM40	RLCK-FAM50	RLCK-FAM63
A1		49	52	57	67	77
A2		122	131	144	162	186.8
B		54	60	65	70	78
C1		□19	□19	□22	□25	□31.8
C2		11	11	13	15	19
C3		9	9	10	11	15
ΦD		Φ8	Φ8	Φ10	Φ12	Φ15
E		25	25	30	35.5	43
F		64	64	77	90	110
G1		55	55	66	77	94
G2		22	22	26	30	36
G3		24	24	29	33	39
H		3	3	4	4	4
ΦI		Φ45	Φ50	Φ58	Φ68	Φ81
J1		55	57	69	75	96
J2		64	65.5	79	87	112
K		42	44	52	58	75
L		Φ6.8-Φ10.5x6.5D.	Φ6.8-Φ10.5x6.5D.	Φ9-Φ13.5x9D.	Φ9-Φ13.5x9D.	Φ11-Φ17x11D.
M		20	22	25	30	36
N		28	29	34.5	39	50
O-Ring		P6	P6	P9	P9	P9
Q		61°	61°	61°	61°	66°
T		4	5	5.5	7.5	7.3

RLCK杠杆式油壓缸(FCM法蘭型油路板附調速)
RLCK Hydraulic Leverage-type Cylinder FCM Flange type manifold with flow control

●油缸內徑Φ25-Φ63 ●最大操作壓力70kg/cm² ●Bore of cylinder(mm):Φ25-Φ63 ●Max pressure:70kg/cm²

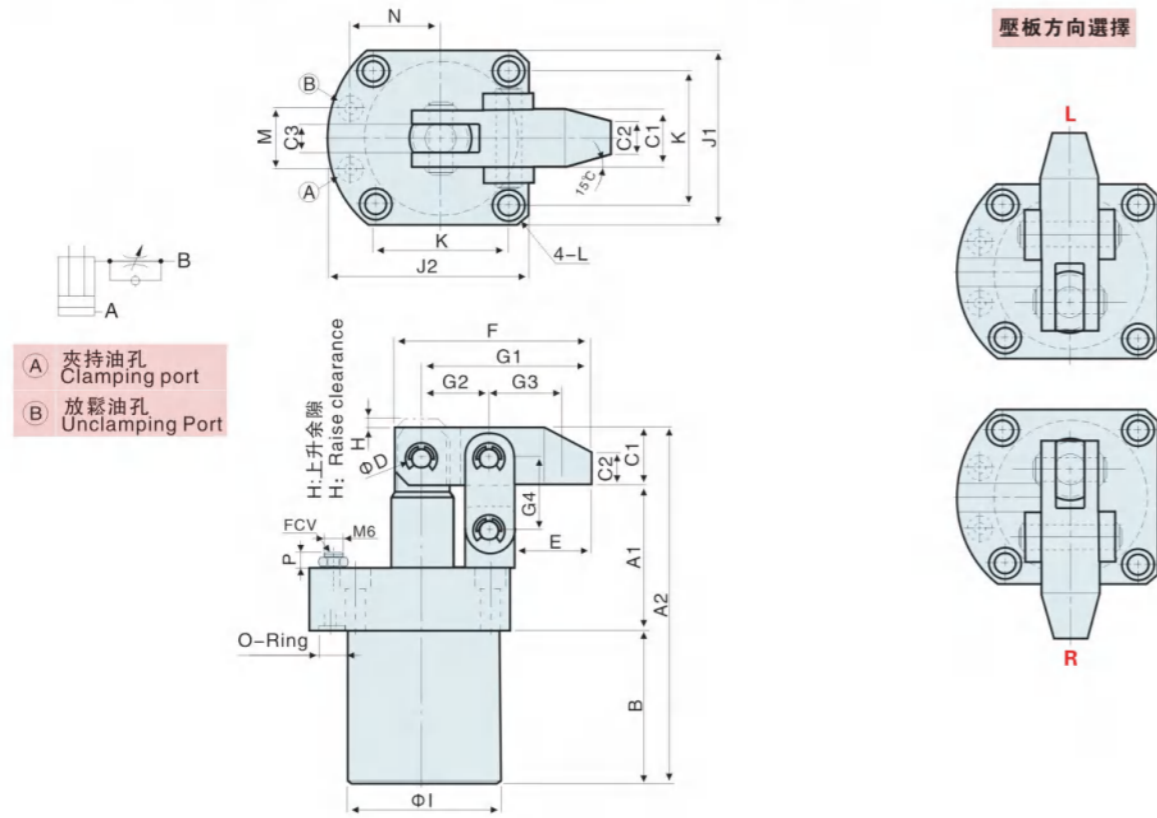

外形尺寸表 Dimension table

ITEM	MODEL	RLCK-FCM25	RLCK-FCM32	RLCK-FCM40	RLCK-FCM50	RLCK-FCM63
A1		49	52	57	67	77
A2		122	131	144.2	162.4	186.8
B		54	60	65	70	78
C1		□19	□19	□22	□25	□31.8
C2		11	11	13	15	19
C3		9	9	10	11	15
ΦD		Φ8	Φ8	Φ10	Φ12	Φ15
E		25	25	30	35.5	43
F		64	64	77	90	110
G1		55	55	66	77	94
G2		22	22	26	30	36
G3		28	28	34	39	48
G4		24	24	29	33	39
H		3	3	4	4	4
ΦI		Φ45	Φ50	Φ58	Φ68	81
J1		55	57	69	75	96
J2		64	65.5	79	87	112
K		42	44	52	58	75
L		Φ6.8-Φ10.5×6.5D.	Φ6.8-Φ10.5×6.5D.	Φ9-Φ14×9D.	Φ9-Φ14×9D.	Φ11-Φ17×11D.
M		20	22	26	30	36
N		28	29	34.5	39	50
O-Ring		P6	P6	P9	P9	P9
P Min.		7	4.5	4.5	4	4
P Max.		9.9	7.8	7.8	7.3	7.3

RLCK杠杆式油壓缸(FAMT法蘭型油路板附調速)
RLCK Hydraulic Leverage-type Cylinder FAMT Flange with flow control

●油缸內徑Φ25-Φ50 ●最大操作壓力50kg/cm² ●Bore of cylinder(mm): Φ25-Φ50 ●Max pressure:50kg/cm²

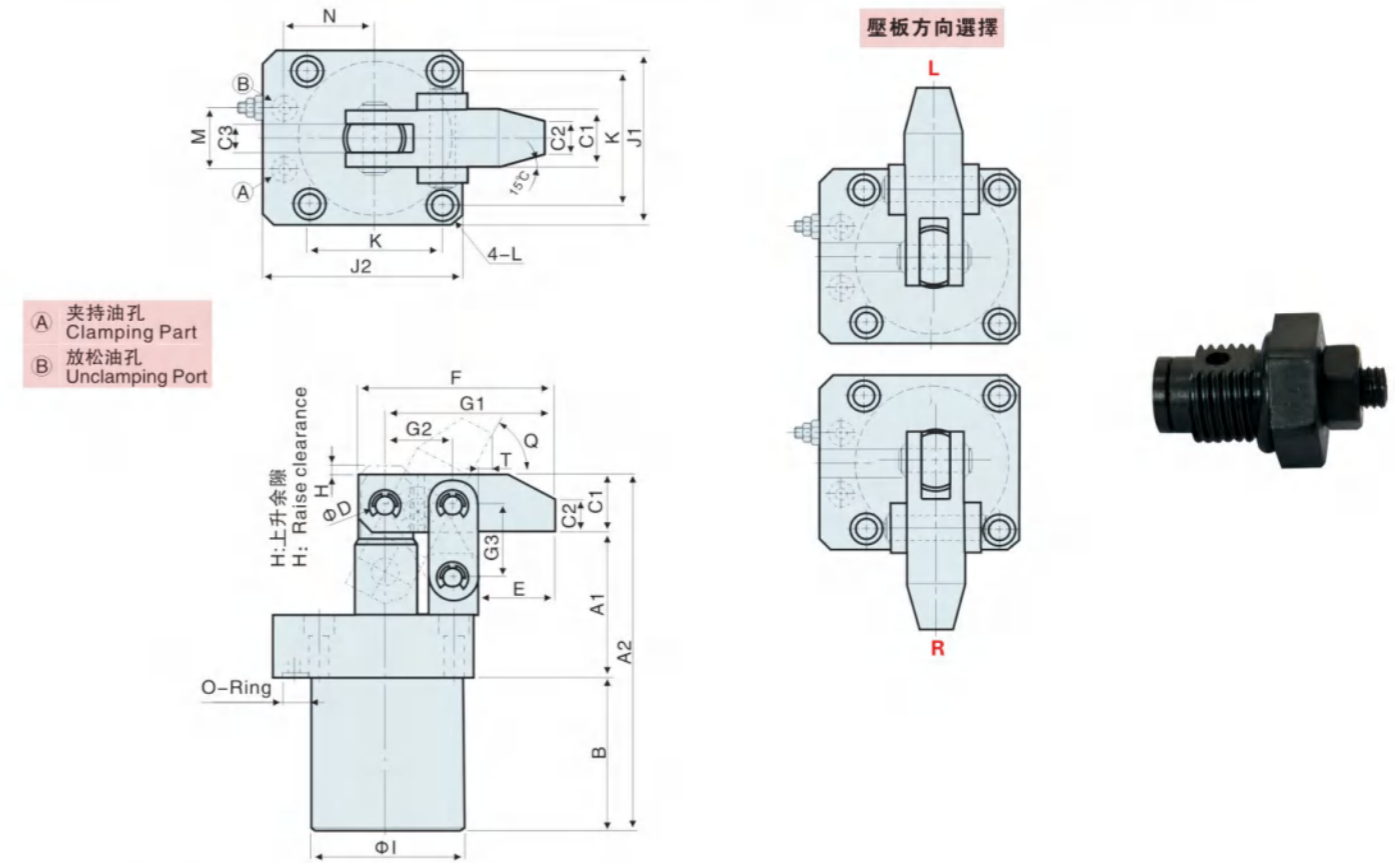

外形尺寸表 Dimension table

ITEM	MODEL	RLCK-FAMT25	RLCK-FAMT32	RLCK-FAMT40	RLCK-FAMT50
A1		49	52	57	67
A2		122	131	144	162
B		54	60	65	70
C1		□19	□19	□22	□25
C2		11	11	13	15
C3		9	9	10	11
ΦD		Φ8	Φ8	Φ10	Φ12
E		25	25	30	35.5
F		64	64	77	90
G1		55	55	66	77
G2		22	22	26	30
G3		24	24	29	33
H		3	3	4	4
ΦI		Φ45	Φ50	Φ58	Φ68
J1		55	57	69	75
J2		64	65.5	79	87
K		42	44	52	58
L		Φ6.8-Φ10.5×6.5D.	Φ6.8-Φ10.5×6.5D.	Φ9-Φ13.5×9D.	Φ9-Φ13.5×9D.
M		20	22	25	30
N		28	29	34.5	39
O-Ring		P6	P6	P9	P9
Q		61°	61°	61°	61°
T		4	5	5.5	7.5

RLCK 杠杆式油壓缸(MF油路板附調速)
RLCK Hydraulic Leverage-type Cylinder MF Manifold with flow control

●油缸內徑Φ25-Φ63 ●最大操作壓力70kg/cm² ●Bore of cylinder(mm):Φ25-Φ63 ●Max pressure:70kg/cm²

RLC-MF63

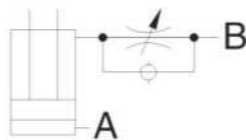
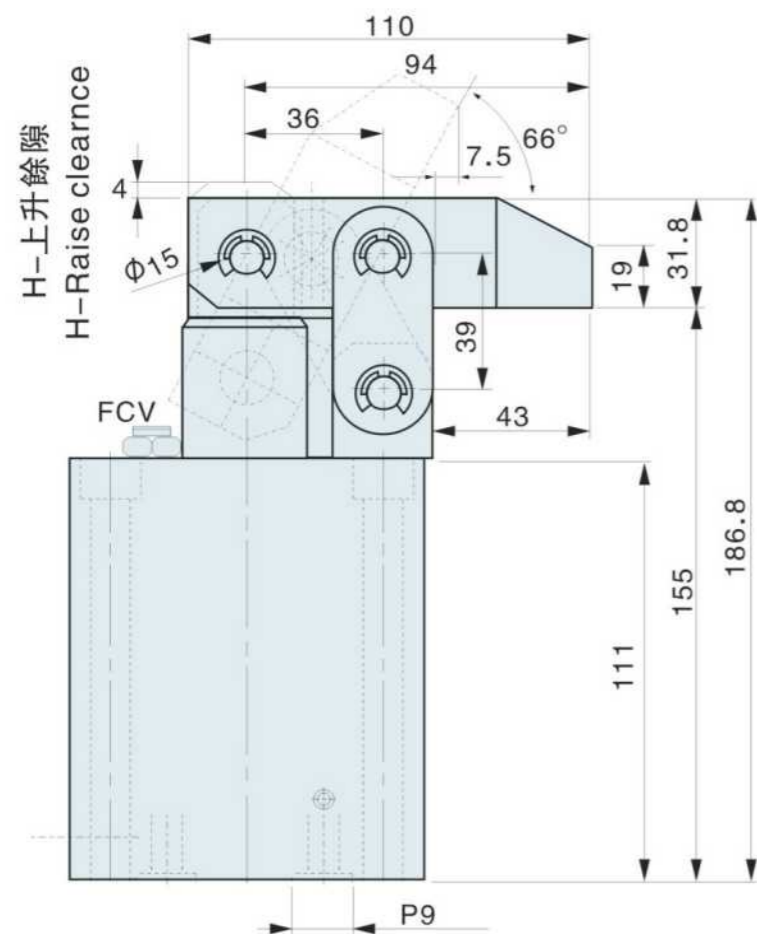
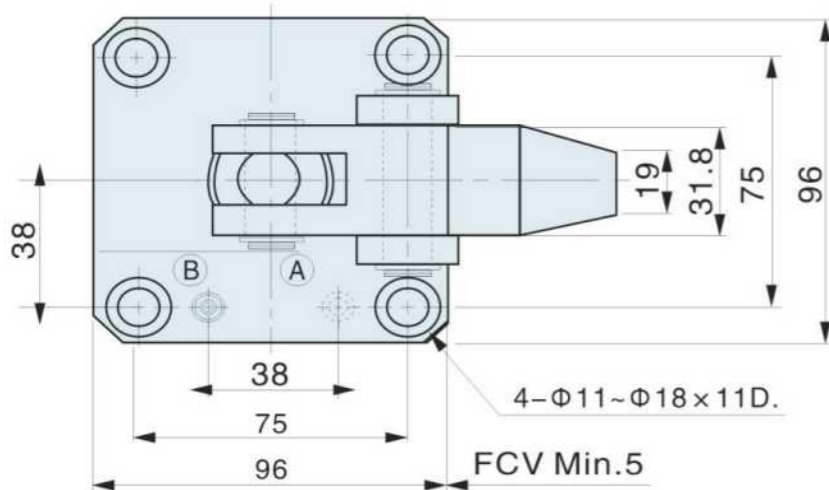

- Ⓐ 夾持油孔
Clamping port
- Ⓑ 放鬆油孔
Unclamping Port

RLCOK 杠杆式油壓缸 RLCOK Hydraulic Leverage-type Cylinder

●油缸內徑Φ25-Φ63 ●最大操作壓力50kg/cm² ●Bore of cylinder(mm):Φ25-Φ63 ●Max pressure:50kg/cm²

產品簡介

- ◆此系列產品有五種可供選擇的缸徑：Φ25, Φ32, Φ40, Φ50, Φ63。
- ◆本產品使用了高性能的密封圈，避免了油缸的泄漏，且其壽命長。
- ◆應用了杠杆原理，使工件容易夾緊，提高效率。
- ◆壓板需增加長度時，請勿大於原長之1.5倍。
- ◆缸體所用的材質是45鋼，活塞材質是45鋼，熱處理，表面鍍鉻。
- ◆缸體一體成型。

Introduction of product

- ◆Five available bore diameter : Φ25, Φ32, Φ40, Φ50, Φ63.
- ◆Use high-quality seal to avoid leakage and keep long operation
- ◆Lever principle design is applied on this hydraulic cylinder. Clamp work piece easily and improve efficiency
- ◆Please don't exceed 1.5 times of the original length, if you need to increase the length of the clamping arm.
- ◆The material of the cylinder body and the piston is 45# steel, heat treatment, chrome plated.
- ◆Cylinder body molding



特性資料 Specification

油缸內徑 Bore of cylinder(mm)	Φ25	Φ32	Φ40	Φ50	Φ63
活塞杆徑 Bore of piston(mm)	Φ14	Φ16	Φ16	Φ20	Φ20
總行程 Total stroke (mm)	22	28	30	30	30
受壓面積推出 Pressure area push(cm ²)	4.91	8.04	12.57	19.63	31.17
理論夾持力 Theoretical Clamping(30kg/cm ²)	單動	70kg	110kg	195kg	330kg
	雙動	113kg	176kg	280kg	449kg
使用流體 Fluid	已濾清之標準液壓油 Filtered oil				
使用溫度範圍 Range of temperature(°C)	-10~+60(°C)				
最大耐壓力 Max operation pressure(kg/cm ²)	70kg/cm ²				
使用壓力範圍 Range of pressure(kg/cm ²)	20~50kg/cm ²				
作動方式 Acting type	單動S或復動D Single Acting S or Double Acting D				
固定方式 Fixing type	上法蘭或外螺紋固定 Upper flange or Threaded Body				

RLCOK 杠杆式油壓缸 RLCOK Hydraulic Leverage-type Cylinder

RL-16 塊型油壓缸 RL-16 Block-type Hydraulic Cylinder

●油缸內徑Φ25-Φ63 ●最大操作壓力50kg/cm² ●Bore of cylinder(mm):Φ25-Φ63 ●Max pressure: 50kg/cm²

●油缸內徑Φ16-Φ40 ●最大壓力35MPa ●Bore of cylinder (mm) : Φ16-Φ40 ●Max pressure: 35MPa

訂購標示法 Ordering Code

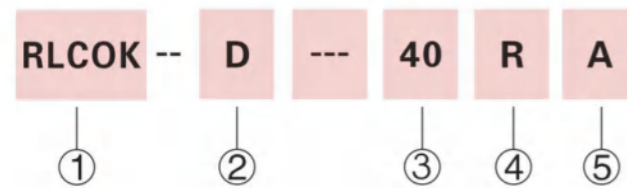

How to place order :

① 系列號 Series	RLCOK
② 作動方式 Acting type	D: 復動式 Double acting S: 單動式 Single acting
③ 油缸內徑 Bore of cylinder	Φ25, Φ32, Φ40, Φ50, Φ63
④ R/L/空白 (壓臂安裝方式)	
⑤ 缸體一體成型	

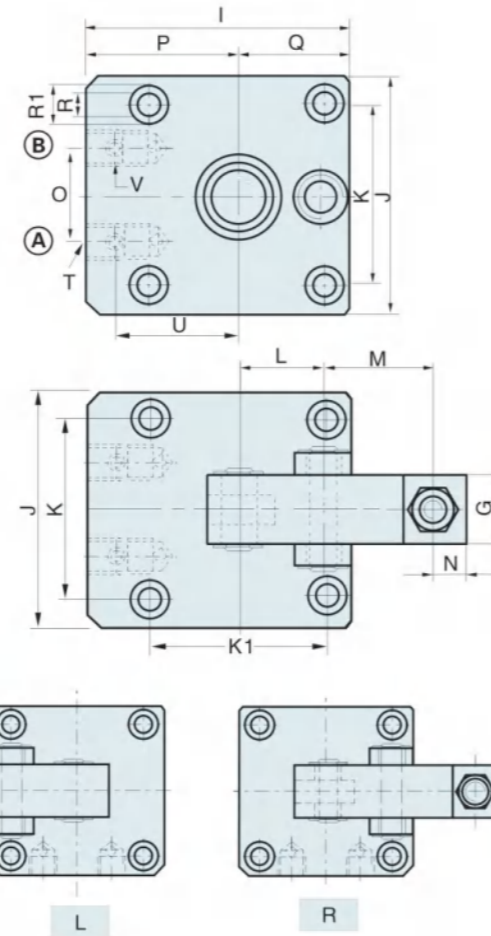
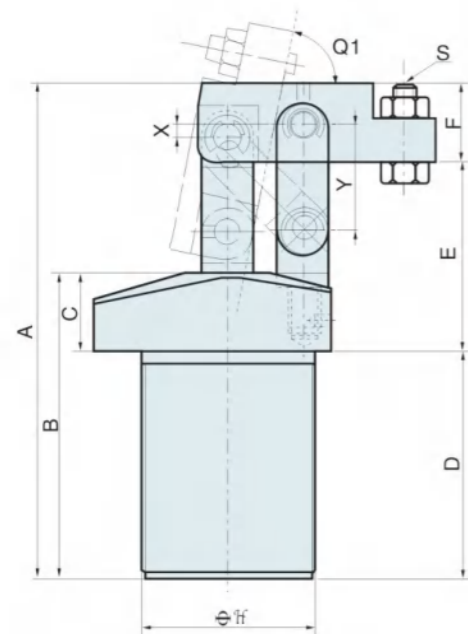

(A) 夾持油孔 Clamping port (B) 放鬆油孔 Unclamping Port

外形尺寸表 Dimension table

單位 (Unit) : mm

ITEM MODEL	A	B	C	D	E	F	G	H	I	J	K	K1	L	M	N	O	P	Q	R	R1	S	T	U	V (O-Ring)	Q1	X	Y
RLCOKS-25 RLCOKD-25	128.5	86.5	25	61.5	50	17	16	M40*1.5	60	50	37	37	18	23	7	23	35	25	5.5	9	M6*1.0	PT1/8	26	P7	75°	4.5	26
RLCOKS-32 RLCOKD-32	149	97	25	72	57	20	18	M50*1.5	70	60	45	45	22	30	8	23	40	30	6.5	11	M8*1.25	PT1/8	30.5	P7	75°	5	33
RLCOKS-40 RLCOKD-40	157	97	25	72	60	25	20	M55*1.5	75	65	50	50	24	32	10	26	42.5	32.5	6.5	11	M8*1.25	PT1/8	33	P7	75°	4	33
RLCOKS-50 RLCOKD-50	174	104	25	79	65	30	22	M65*1.5	88	75	58	58	27.5	36	14	32	50.5	37.5	8.5	14	M12*1.75	PT1/8	38	P7	65°	10	44
RLCOKS-63 RLCOKD-63	179	105	25	80	69	30	22	M80*1.5	108	90	70	70	32	42	14	35	63	45	8.5	14	M12*1.75	PT1/8	48	P7	60°	10	48

產品簡介

- ◆此型式塊形缸為低位擺固定式油缸，單作用，彈簧復位，最大操作壓力35MPa。
- ◆此型式油缸由一固定於低位之中心點，作擺動推動，因此能提供（二維分力），向前水平推力及向下垂直分力。
- ◆能讓工件向前抵位及向下固着于底座上，力量大小視接觸點角度而定。亦可轉換各種搖臂作為夾持用。

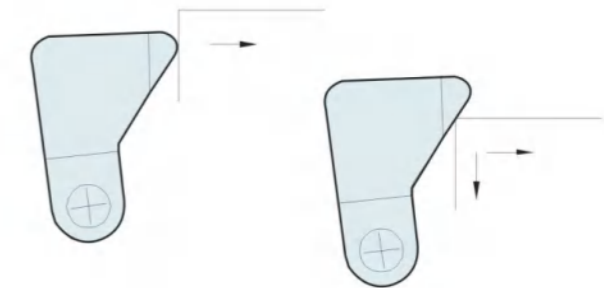
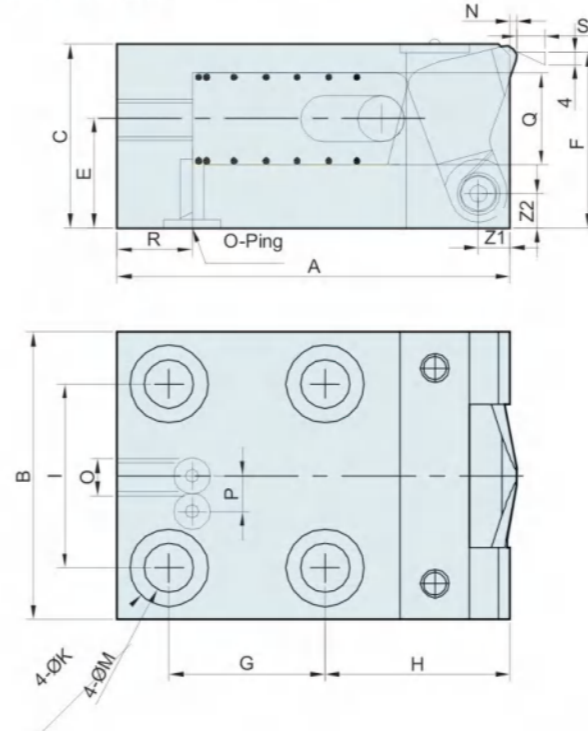

外形尺寸表 Dimension table

A	mm	68
B	mm	50
C	mm	32
D	mm	6
E	mm	19
F	mm	31
G	mm	27
H	mm	32
I	mm	32
K	mm	13.5
I1	mm	8.5
M	mm	8.5
N	mm	2
O	mm	PT1/4
P	mm	-
R	mm	13
Z1	mm	5.5
Z2	mm	6
Q	mm	16
ST	mm	8
o-Ping	mm	P7
夾持力100/500bar		1.7/8.5KN
最大操作压力		25Mpa